

MAGPLATE DIRECT

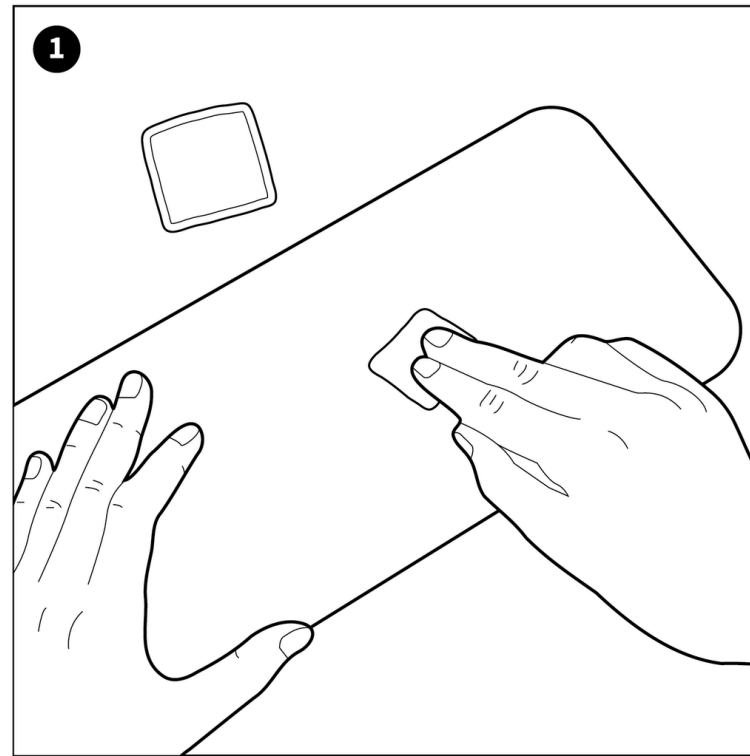

1 Prep Plate Surface

Wipe the rear face of the number plate with the supplied alcohol wipe, wait 30 seconds until completely dry.

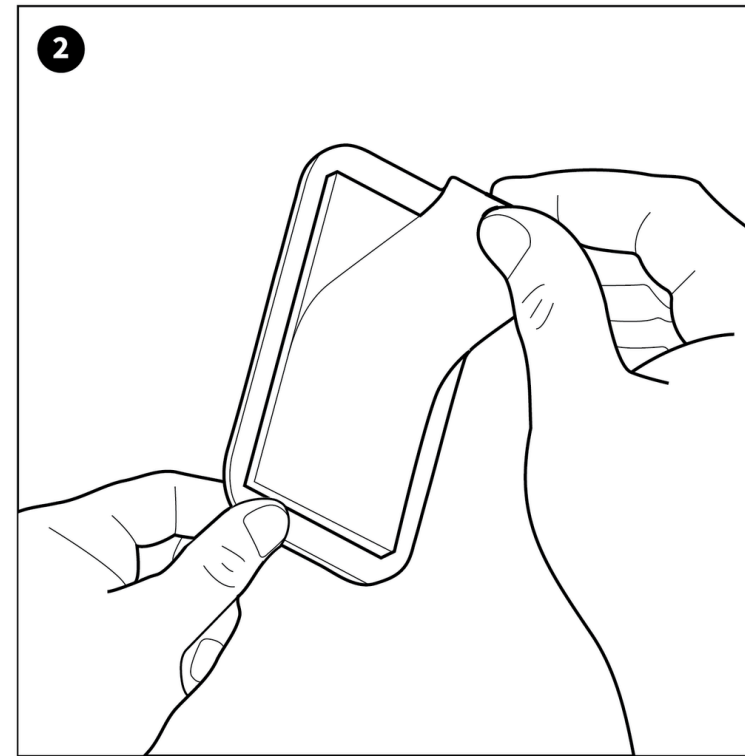

2 Peel Liner

Peel the liner from a puck.

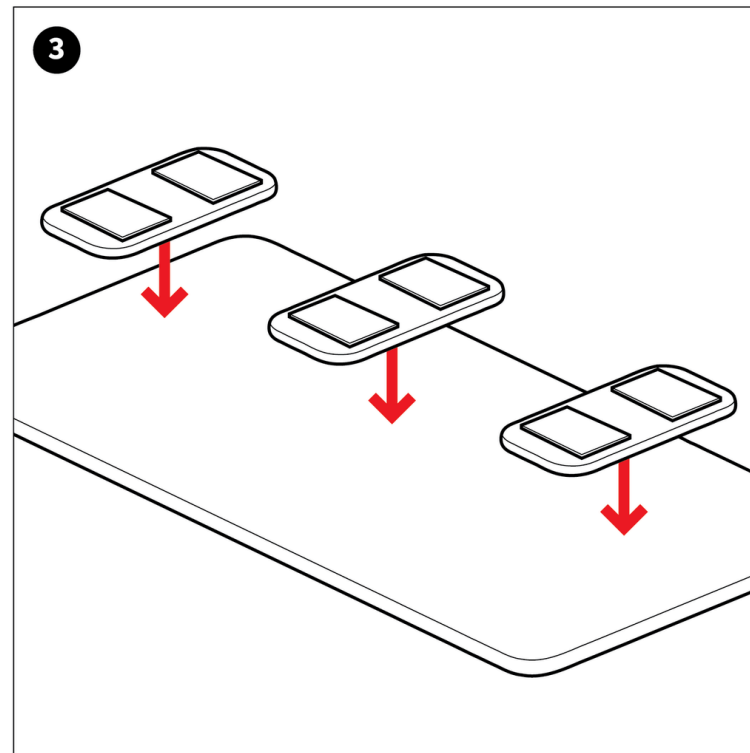

3 Attach Pucks

Press firmly to the plate for 20 seconds; repeat for the other two, spacing them evenly.



4 Snap & Go

Snap the plate on and off as needed.